

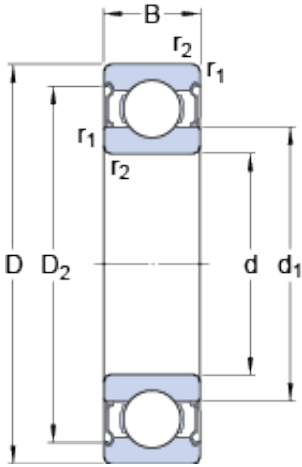

SKF Wheel Bearings DEVELOP MFG.CORP.



60 mm x 110 mm x 22 mm SKF 6212-2Z/VA201 deep groove ball bearings

Bearing No. 6212-2Z/VA201

6212-2Z/VA201 Bearing 2D drawings and 3D CAD models

Size	110x60x22 mm
Bore Diameter	110 mm
Outer Diameter	60 mm
Width	22 mm
d	60 mm
D	110 mm
B	22 mm
d ₁	75.5 mm
D ₂	98 mm
r _{1,2} - min.	1.5 mm
d _a - min.	69 mm
d _a - max.	75.4 mm
D _a - max.	101 mm
r _a - max.	1.5 mm
Basic dynamic load rating - C	55.3 kN
Basic static load rating - C ₀	36 kN
Limiting speed	50 r/min
Limiting temperature - T	250 ° C
Category	Single Row Ball Bearings
Inventory	0.0
Manufacturer Name	SKF
Minimum Buy Quantity	N/A
Weight / Kilogram	0.837
EAN	7316571268286



SKF Wheel Bearings DEVELOP MFG.CORP.

Product Group	B00308
Enclosure	2 Metal Shields
Precision Class	ABEC 1 ISO P0
Maximum Capacity / Filling Slot	No
Rolling Element	Ball Bearing
Snap Ring	No
Internal Special Features	Polyalkylene Glycol/Graphite Mixture Filled
Cage Material	Steel
Internal Clearance	C0-Medium
Inch - Metric	Metric
Long Description	60MM Bore; 110MM Outside Diameter; 22MM Outer Race Width; 2 Metal Shields; Ball Bearing; ABEC 1 ISO P0; No Filling Slot; No Snap Ring; Polyalkylene Glycol/Graphite Mixture Filled Internal Special Fe
Other Features	Deep Groove Extreme Temperature Variant
Category	Single Row Ball Bearing
UNSPSC	31171504
Harmonized Tariff Code	8482.10.50.68
Noun	Bearing
Keyword String	Ball
Manufacturer URL	http://www.skf.com
Manufacturer Item Number	6212-2Z/VA201
Weight / LBS	0.81
Outside Diameter	4.331 Inch 110 Millimeter
Inner Race Width	0 Inch 0 Millimeter
Bore	2.362 Inch 60 Millimeter
Outer Race Width	0.866 Inch 22 Millimeter
bore diameter:	60 mm



SKF Wheel Bearings DEVELOP MFG.CORP.

precision rating:	Not Rated
outside diameter:	110 mm
finish/coating:	Uncoated
overall width:	22 mm
cage material:	Steel
bore type:	Round
outer ring width:	22 mm
closure type:	Double Shielded
fillet radius:	1.5 mm
row type & fill slot:	Single Row Non-Fill Slot
maximum rpm:	100 RPM
internal clearance:	C0
series:	62
operating temperature range:	-20 to +480 ° F
resistance features:	Corrosion Resistant, Extreme Temperature
static load capacity:	36 kN
d_1	75.5 mm
D_2	98 mm
$r_{1,2}$ min.	1.5 mm
d_a min.	69 mm
d_a max.	75.4 mm
D_a max.	101 mm
r_a max.	1.5 mm
Basic dynamic load rating C	55.3 kN
Basic static load rating C_0	36 kN
Limiting temperature T max.	250 ° C
Mass bearing	0.81 kg